

IX-MV7-W

IP Video Answering Station

The IX-MV7-W is an IP video answering station with a 7" touchscreen. It connects to a network using Cat-5e/6 cable and is SIP compliant. The included desk stand can be used or the station can be mounted to a wall.

Audio and video of active conversations can be stored on a microSD™ card. Each IX-MV7-W can be used to monitor one station or scan monitor up to 500 stations within its address book. It has line supervision and scheduled device check of all addressed stations. It can page all units or select groups of units. The bell schedule can handle up to 50 events per day.

The answering station has eight speed dial buttons that can be used to call, page, monitor, or control a contact closure. It has a camera with privacy shutter. The IX-MV7-W can view a selected intercom's camera as well as an associated ONVIF® Profile S camera by using the picture-in-picture function. Door release will only unlock the entrance that is associated with the connected door station. Stations can be called by using the directory or by direct dialing the station's number.

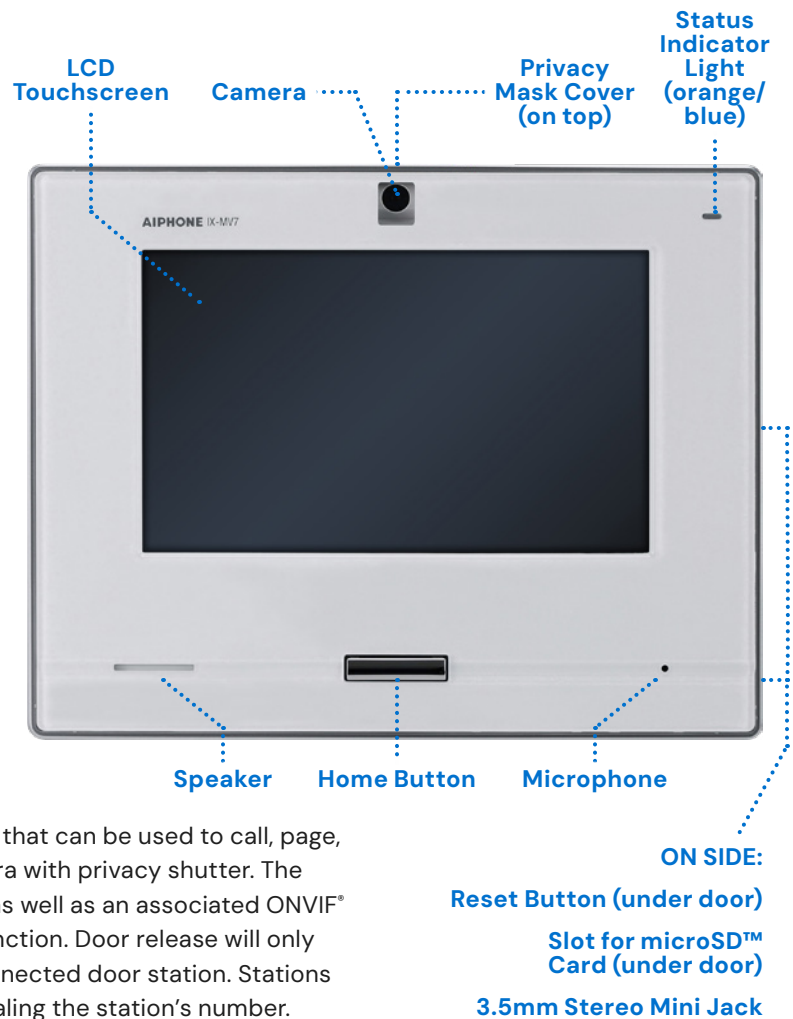

- 7" LCD touchscreen
- Fixed video camera with privacy shutter
- SIP compliant
- 500 station address book
- ONVIF® Profile S compliant
- Multi-angled desk stand (30°, 45°, 60°)
- Memory can be expanded with microSD™ card
- PoE (802.3af)
- Two contact outputs
- Four trigger inputs
- 8Ω 0.5W speaker output
- 600Ω audio input

Power Source	PoE (IEEE 802.3af class 0)
Power Draw	4.32W
Camera	1/3" CMOS 480p
Min Illumination	5 lux
Audio Codec	G.711 (μ-law, A-law), G.722
Video Codec	H.264/AVC, motion JPEG
Protocols	IPv4, IPv6, TCP, UDP, SIP, HTTP, HTTPS, RTSP, RTP, RTCP, IGMP, MLD, SMTP, SFTP, DHCP, NTP, DNS
Port Security	IEEE 802.1X
UL Listed	UL 62368-1 cUL 62368-1
Communication	Hands-free (full-duplex) or push-to-talk (simplex)
Operating Temp	32° ~ 104°F (-0° ~ 40°C)
Dimensions	6-3/4" H x 8-11/16" W x 1-1/4" D